

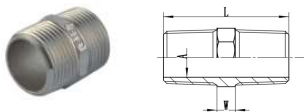
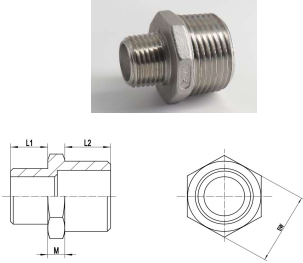

Doppelnippel Edelstahl - 1.4408		Artikelnummer	Dim.		DN	L	W	A	Squares	Gewindelänge	Z
	81999	1/8"		6	20	4	5.5		Hex	8.0	4
	82000	1/4"		8	25	4	8		Hex	10.5	4
	82001	3/8"		10	27	5	11.5		Hex	11.0	5
	82002	1/2"		15	34	5	15		Hex	9.5	5
	82003	3/4"		20	36.5	5.5	20.5		Oct	15.5	5.5
	82004	1"		25	42	6	26		Oct	18.0	6
	82005	1 1/4"		32	47.5	6.5	34.5		Oct	20.5	6.5
	82006	1 1/2"		40	47.5	6.5	40		Oct	20.5	6.5
	82007	2"		50	57	7	51		Oct	25.0	7
	82008	2 1/2"		65	61	7	65.5		Dec	27.0	7
	82009	3"		80	67.5	7.5	77.5		Dec	30.0	7.5
82010	4"		100	80	8	101.5		Dec	36.0	8	

Doppelnippel Reduziert Edelstahl - 1.4408		Artikelnummer	Dim. L2	Dim. L1	DN	L1	M	L2	SW	Square	Gewindelänge L1	Gewindelänge L2
	82440	1/4"	1/8"	8x6	8	4	10.5	14.5	18	Hex	8	10.5
	82441	3/8"	1/8"	10x6	8	5	11	18	18	Hex	8	11
	82442	3/8"	1/4"	10x8	10.5	5	11	18	18	Hex	10.5	11
	82443	1/2"	1/8"	15x6	8	5	14.5	22	22	Hex	8	14.5
	82444	1/2"	1/4"	15x8	10.5	5	14.5	22	22	Hex	10.5	14.5
	82445	1/2"	3/8"	15x10	11	5	14.5	22	22	Hex	11	14.5
	82446	3/4"	1/4"	20x8	10.5	5.5	15.5	28	28	Oct	10.5	15.5
	82447	3/4"	3/8"	20x10	11	5.5	15.5	28	28	Oct	11	15.5
	82448	3/4"	1/2"	20x15	14.5	5.5	15.5	28	28	Oct	14.5	15.5
	82449	1"	1/4"	25x8	11	9	18	35	35	Oct	11	18
	82450	1"	3/8"	25x10	11	6	18	35	35	Oct	11	18
	82451	1"	1/2"	25x15	14.5	6	18	35	35	Oct	14.5	18
	82452	1"	3/4"	25x20	15.5	6	18	35	35	Oct	15.5	18
	82453	1 1/4"	1/2"	32x15	14.5	6.5	20.5	43.5	43.5	Oct	14.5	20.5
	82454	1 1/4"	3/4"	32x20	15.5	6.5	20.5	43.5	43.5	Oct	15.5	20.5
	82455	1 1/4"	1"	32x25	18	6.5	20.5	43.5	43.5	Oct	18	20.5
	82456	1 1/2"	1/2"	40x15	14.5	6.5	20.5	49	49	Oct	14.5	20.5
	82457	1 1/2"	3/4"	40x20	15	6.5	20.5	49	49	Oct	15	20.5
	82458	1 1/2"	1"	40x25	18	6.5	20.5	49	49	Oct	18	20.5
	82459	1 1/2"	1 1/4"	40x32	20.5	6.5	20.5	49	49	Oct	20.5	20.5
	82460	2"	1/2"	50x15	14	12	24	62	62	Oct	14	24
	82461	2"	3/4"	50x20	15.5	7	25	61.5	61.5	Oct	15.5	25
	82462	2"	1"	50x25	18	7	25	61.5	61.5	Oct	18	25
	82463	2"	1 1/4"	50x32	20.5	7	25	61.5	61.5	Oct	20.5	25
	82464	2"	1 1/2"	50x40	20.5	7	25	61.5	61.5	Oct	20.5	25
	82465	2 1/2"	1 1/2"	65x40	20.5	7	27	77	77	Dec	20.5	27
	82466	2 1/2"	2"	65x50	25	7	27	77	77	Dec	25	27
82467	3"	2"	80x50	25	7.5	30	90.5	90.5	Dec	25	30	
82468	3"	2 1/2"	80x65	27	7.5	30	90.5	90.5	Dec	27	30	
82470	4"	2 1/2"	100x65	27	8	36	116.5	116.5	Dec	27	36	
82471	4"	3"	100x80	30	8	36	116.5	116.5	Dec	30	36	

T-Stück Edelstahl - 1.4408		Artikelnummer	Dim.		DN	L	A	B	t	Gewindelänge	Z
	82011	1/8"		6	17	14.5	13	2	2	4.5	12.5
	82012	1/4"		8	19	18	16.5	2	2	6.7	12.3
	82013	3/8"		10	23	21.5	20	2	2	7.1	15.9
	82014	1/2"		15	27	26	24.5	1.8	1.8	9.1	17.9
	82015	3/4"		20	32	31.5	30	1.8	1.8	10.4	21.6
	82016	1"		25	38	39	37.5	2	2	11.6	26.4
	82017	1 1/4"		32	45	48	46.5	2.4	2.4	13.9	31.1
	82018	1 1/2"		40	48	55	53	2.5	2.5	13.9	34.1
	82019	2"		50	57	67.5	65.5	2.8	2.8	17.1	39.9
	82020	2 1/2"		65	69	84	82	3.3	3.3	18.7	50.3
	82021	3"		80	78	98.5	95.5	3.8	3.8	21.8	56.2
82022	4"		100	96	124.5	121.5	4.3	4.3	26.6	69.4	

T-Stück reduziert Edelstahl - 1.4408		Artikelnummer	Inch for side A	Inch for side G	DN	L1	L2	G	H	t	A	B	T	Gewindelänge A	Gewindelänge G	Z - Seite A	Z - Seite G
	82480	1/4"	1/8"	8x6	18	18	14	13	1.6	1.6	18	16.5	1.6	6.7	4.5	11.3	13.5
	82482	3/8"	1/4"	10x8	20	22	18	16.5	1.6	1.6	21.5	20	1.6	7.1	6.7	12.9	15.3
	82483	1/2"	1/4"	15x8	24	24	18	16.5	1.6	1.6	26	24.5	1.8	9.1	6.7	14.9	17.3
	82484	1/2"	3/8"	15x10	26	25	21.5	20	1.6	1.6	26	24.5	1.8	9.1	7.1	16.9	17.9
	82485	3/4"	3/8"	20x10	28	28	21.5	20	1.6	1.6	31.5	30	1.8	10.4	7.1	17.6	20.9
	82486	3/4"	1/2"	20x15	29	30	26	24.5	1.8	1.8	31.5	30	1.8	10.4	9.1	18.6	20.9

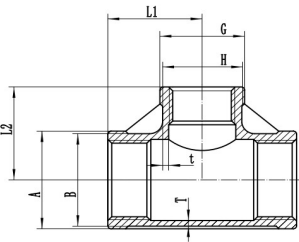

82487	1"	1/2"	25x15	34	35	26	24.5	1.8	39	37.5	2	11.6	9.1	20.4	23.9
82488	1"	3/4"	25x20	34	35	31.5	30	1.8	39	37.5	2	11.6	10.4	22.4	24.6
82489	1 1/4"	1/2"	32x15	33.2	38.5	27	25	1.8	49.5	47	2.3	13.9	9.1	19.3	29.4
82490	1 1/4"	3/4"	32x20	38	40	31.5	30	1.8	48	46.5	2.4	13.9	10.4	24.1	29.6
82491	1 1/4"	1"	32x25	40	42	39	37.5	2	48	46.5	2.4	13.9	11.6	26.1	30.4
82492	1 1/2"	1/2"	40x15	35	41	27	25	1.8	56	53.5	2.3	13.9	9.1	21.1	31.9
82493	1 1/2"	3/4"	40x20	39	41.7	32	30.5	1.8	55	53.5	2.5	13.9	10.4	25.1	31.3
82494	1 1/2"	1"	40x25	41	45	39	37.5	2	55	53	2.5	13.9	11.6	27.1	33.4
82495	1 1/2"	1 1/4"	40x32	45	48	48	46.5	2.4	55	53	2.5	13.9	13.9	31.1	34.1
82496	2"	3/4"	50x20	40	50	31.5	30	1.8	67.5	65.5	2.8	17.1	10.4	22.9	39.6
82497	2"	1"	50x25	42	52	39	38	2	67.5	65.5	2.8	17.1	11.6	24.9	40.4
82498	2"	1 1/4"	50x32	48	54	48	46.5	2.4	67.5	65.5	2.8	17.1	13.9	30.9	40.1
82499	2"	1 1/2"	50x40	52	55	55	53	2.5	67.5	65.5	2.8	17.1	13.9	34.9	41.1

"Y" - Edelstahl - 1.4408

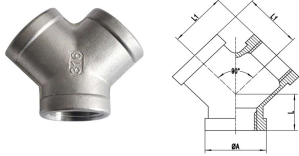

Artikelnummer	Inch	DN	A	L	L1	Gewindelänge	Z
83070	3/8"	10	20.3	18	22.8	7.1	10.9
83071	1/2"	15	27	21	28	9.1	11.9
83072	3/4"	20	32.3	20	30.8	10.4	9.6
83073	1"	25	40.4	29	38.8	11.6	17.4
83074	1 1/4"	32	47.5	27	41	13.9	13.1
83075	1 1/2"	40	56	37	47.5	13.9	23.1
83076	2"	50	68.1	38	57	17.1	20.9

Kreuz Edelstahl - 1.4408

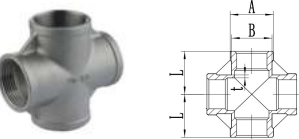

Artikelnummer	Inch	DN	L	A	B	t	Gewindelänge	Z
82030	1/8"	6	17	14.5	13	1.8	4.5	12.5
82031	1/4"	8	19	18	16.5	1.8	6.7	12.3
82032	3/8"	10	23	21.5	20	1.8	7.1	15.9
82033	1/2"	15	27	26	24.5	1.8	9.1	17.9
82034	3/4"	20	32	31.5	30	1.8	10.4	21.6
82035	1"	25	38	39	37.5	2	11.6	26.4
82036	1 1/4"	32	45	48	46.5	2.4	13.9	31.1
82037	1 1/2"	40	48	55	53	2.5	13.9	34.1
82038	2"	50	57	67.5	65.5	2.8	17.1	39.9
82039	2 1/2"	65	69	84	82	3.3	18.7	50.3
82040	3"	80	78	98.5	95.5	3.8	21.8	56.2
82041	4"	100	96	124.5	121.5	4.3	26.6	69.4

Muffe Edelstahl - 1.4408

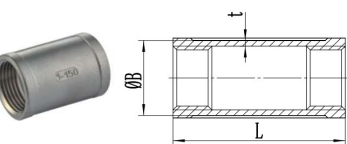

Artikelnummer	Inch	DN	L	B	t	Gewindelänge	Z
82070	1/8"	6	17	13	1.6	4.5	8.0
82071	1/4"	8	24	16.5	1.6	6.7	10.6
82072	3/8"	10	25	20	1.6	7.1	10.8
82073	1/2"	15	32	24.5	1.8	9.1	13.8
82074	3/4"	20	35	30	1.8	10.4	14.2
82075	1"	25	55	37.5	2	11.6	31.8
82076	1 1/4"	32	65	46.5	2.4	13.9	37.2
82077	1 1/2"	40	65	53	2.5	13.9	37.2
82078	2"	50	70	65.5	2.8	17.1	35.8
82079	2 1/2"	65	75	82	3.3	18.7	37.6
82080	3"	80	80	95.5	3.8	21.8	36.4
82081	4"	100	92	121.5	4.3	26.6	38.8

Reduziermuffe Edelstahl - 1.4408

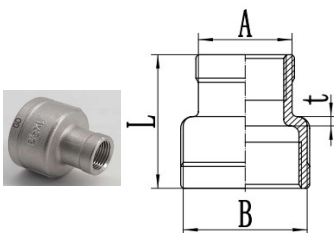

Artikelnummer	Inch for side B	Inch for side A	DN	A	B	L	t	Gewindelänge Seite B	Gewindelänge Seite A	Z
82500	1/4"	1/8"	8x6	13	16.5	25	3	6.7	4.5	10.8
82501	3/8"	1/8"	10x6	13	20	26	3	7.1	4.5	11.5
82502	3/8"	1/4"	10x8	16.5	20	26	3	7.1	6.7	9.3
82503	1/2"	1/8"	15x6	13	24.5	34	3	9.1	4.5	17.4
82504	1/2"	1/4"	15x8	16.5	24.5	34	3	9.1	6.7	15.2
82505	1/2"	3/8"	15x10	20	24.5	34	3	9.1	7.1	14.8
82506	3/4"	1/4"	20x8	16.5	30	36	3	10.4	6.7	15.9
82507	3/4"	3/8"	20x10	20	30	36	3	10.4	7.1	15.5
82508	3/4"	1/2"	20x15	24.5	30	36	3	10.4	9.1	13.5
82509	1"	1/4"	25x8	15	38	37	3	11.6	6.7	15.8
82510	1"	3/8"	25x10	20	37.5	42	3.5	11.6	7.1	19.9
82511	1"	1/2"	25x15	24.5	37.5	42	3.5	11.6	9.1	17.8
82512	1"	3/4"	25x20	30	37.5	42	3.5	11.6	10.4	16.5

82513	11/4"	1/4"	32×8	15	48.5	39.5		3	13.9	6.7	16.0
82514	11/4"	3/8"	32×10	18.5	48.5	41.5		3	13.9	7.1	17.6
82515	11/4"	1/2"	32×15	24.5	48.5	48		3.75	13.9	9.1	21.3
82516	11/4"	3/4"	32×20	30	48.5	48		3.75	13.9	10.4	20.0
82517	11/4"	1"	32×25	37.5	48.5	48		3.75	13.9	11.6	18.8
82518	11/2"	3/8"	40×10	18.5	53	43		3	13.9	7.1	19.1
82519	11/2"	1/2"	40×15	24.5	53	52		4	13.9	9.1	25.0
82520	11/2"	3/4"	40×20	30	53	52		4	13.9	10.4	23.7
82521	11/2"	1"	40×25	37.5	53	52		4	13.9	11.6	22.6
82522	11/2"	1 1/4"	40×32	46.5	53	52		4	13.9	13.9	20.3
82523	2"	1/2"	50×15	25.5	65	45		3.5	17.1	9.1	15.3
82524	2"	3/4"	50×20	30	65.5	58		4.5	17.1	10.4	26.0
82525	2"	1"	50×25	37.5	65.5	58		4.5	17.1	11.6	24.9
82526	2"	1 1/4"	50×32	46.5	65.5	58		4.5	17.1	13.9	22.6
82527	2"	1 1/2"	50×40	53	65.5	58		4.5	17.1	13.9	22.6
82528	2 1/2"	1"	65×25	37.5	81.5	64.5		5	18.7	11.6	29.3
82529	2 1/2"	1 1/4"	65×32	46.5	81.5	64.5		5	18.7	13.9	27.0
82530	2 1/2"	1 1/2"	65×40	53	81.5	65		5	18.7	13.9	27.5
82531	2 1/2"	2"	65×50	65.5	81.5	65		5	18.7	17.1	24.3
82532	3"	1 1/4"	80×32	46.5	95	72		6	21.8	13.9	30.4
82533	3"	1 1/2"	80×40	53	95	72		6	21.8	13.9	30.4
82534	3"	2"	80×50	65.5	95.5	72		6	21.8	17.1	27.2
82535	3"	2 1/2"	80×65	82	95.5	72		6	21.8	18.7	25.6
82536	4"	1 1/2"	100×40	53	121.5	93		6	26.6	13.9	46.6
82537	4"	2"	100×50	65.5	121.5	93		6	26.6	17.1	43.4
82538	4"	2 1/2"	100×65	82	121.5	94		6	26.6	18.7	42.8
82539	4"	3"	100×80	95.5	121.5	94		6	26.6	21.8	39.7

Schlauchnippel Edelstahl - 1.4408		Artikelnummer	Inch	DN	L	A	B	S	Gewindelänge	Z
		82110	1/8"	6	41	8	24	12.8	4.5	12.5
		82111	1/4"	8	42.5	9	28	15	6.7	7.8
		82112	3/8"	10	49	11.5	33	18	7.1	8.9
		82113	1/2"	15	57.5	15	38	22	9.1	10.4
		82114	3/4"	20	66	20	45	28	10.4	10.6
		82115	1"	25	76	27	52	35	11.6	12.4
		82116	1 1/4"	32	79	33	52	44	13.9	13.1
		82117	1 1/2"	40	83	39.5	56	50	13.9	13.1
		82118	2"	50	92	52	60	61.5	17.1	14.9
		82119	2 1/2"	65	99	67	65	78	18.7	15.3
		82120	3"	80	107.5	80	70	90	21.8	15.7
		82121	4"	100	146	103	91.5	117	26.6	27.9

Winkel 90° IG/IG Edelstahl - 1.4408		Artikelnummer	Inch	DN	L	A	B	t	Gewindelänge	Z
		82130	1/8"	6	17	14.5	13	2	4.5	12.5
		82131	1/4"	8	19	18	16.5	2	6.7	12.3
		82132	3/8"	10	23	21.5	20	2	7.1	15.9
		82133	1/2"	15	27	26	24.5	1.8	9.1	17.9
		82134	3/4"	20	32	31.5	30	1.8	10.4	21.6
		82135	1"	25	38	39	37.5	2	11.6	26.4
		82136	1 1/4"	32	45	48	46.5	2.4	13.9	31.1
		82137	1 1/2"	40	48	55	53	2.5	13.9	34.1
		82138	2"	50	57	67.5	65.5	2.8	17.1	39.9
		82139	2 1/2"	65	69	84	82	3.3	18.7	50.3
		82140	3"	80	78	98.5	95.5	3.8	21.8	56.2
		82141	4"	100	96	124.5	121.5	4.3	26.6	69.4

Winkel 90° IG/AG Edelstahl - 1.4408		Artikelnummer	Inch	DN	L	A	B	t	H	I	Gewindelänge	Z1 - Seite L	Z2 - Seite H
		82150	1/8"	6	26	14.5	13	1.8	17	5.5	4.5	21.5	12.5
		82151	1/4"	8	27	17.5	16.5	1.8	19	8	6.7	20.3	12.3
		82152	3/8"	10	29	21	20	1.8	23	11.5	7.1	21.9	15.9
		82153	1/2"	15	35	26	24.5	1.8	27	15	9.1	25.9	17.9
		82154	3/4"	20	40	31.5	30	1.8	32	20.5	10.4	29.6	21.6
		82155	1"	25	46	39	37.5	2	38	26	11.6	34.4	26.4
		82156	1 1/4"	32	54	48	46.5	2.4	45	34.5	13.9	40.1	31.1
		82157	1 1/2"	40	57	55	53	2.5	48	40	13.9	43.1	34.1
		82158	2"	50	70	67	65.5	2.8	57	51	17.1	52.9	39.9
		82159	2 1/2"	65	83	84	82	3.3	69	65.5	18.7	64.3	50.3
		82160	3"	80	94	97.5	95.5	3.7	78	77.5	21.8	72.2	56.2
		82161	4"	100	115	123	121.5	4.2	97	101.5	26.6	88.4	70.4

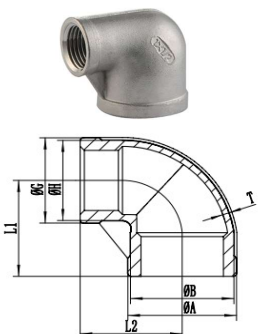
Winkel 90° reduziert IG/IG Edelstahl - 1.4408		Artikelnummer	Inch for side A	Inch for side G	DN	L1	L2	G	H	A	B	T	Gewindelänge Seite A	Gewindelänge Seite G	Z1	Z2
	82540	1/4"	1/8"	8x6	18	18	14	13	18	16.5	16.5	1.6	6.7	4.5	11.3	13.5
	82541	3/8"	1/4"	10x8	20	22	18	16.5	21.5	20	20	1.6	7.1	6.7	12.9	15.3
	82542	1/2"	3/8"	15x10	26	25	21.5	20	26	24.5	24.5	1.8	9.1	7.1	16.9	17.9
	82543	3/4"	3/8"	20x10	28	28	21.5	20	31.5	30	30	1.8	10.4	7.1	17.6	20.9
	82544	3/4"	1/2"	20x15	29	30	26	24.5	31.5	30	30	1.8	10.4	9.1	18.6	20.9
	82545	1"	1/2"	25x15	32	33	26	24.5	39	37.5	39	2	11.6	9.1	20.4	23.9
	82546	1"	3/4"	25x20	34	35	31.5	30	39	37.5	39	2	11.6	10.4	22.4	24.6
	82547	1 1/4"	3/4"	32x20	38	40	31.5	30	48	46.5	48	2.4	13.9	10.4	24.1	29.6
	82548	1 1/4"	1"	32x25	40	42	39	37.5	48	46.5	48	2.4	13.9	11.6	26.1	30.4
	82550	1 1/2"	1"	40x25	41	45	39	37.5	55	53	55	2.5	13.9	11.6	27.1	33.4
82552	2"	1 1/2"	50x40	52	55	55	53	67.5	65.5	67.5	2.8	17.1	13.9	34.9	41.1	

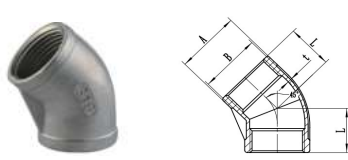
Winkel 45° IG/IG Edelstahl - 1.4408		Artikelnummer	Inch	DN	L	A	B	t	Gewindelänge	Z
	82170	1/8"	6	16	14.5	13	2.3	4.5	11.5	
	82171	1/4"	8	17	18	16.5	2.55	6.7	10.3	
	82172	3/8"	10	19	21.5	20	2.55	7.1	11.9	
	82173	1/2"	15	21	26	24.5	1.8	9.1	11.9	
	82174	3/4"	20	25	31.5	30	1.8	10.4	14.6	
	82175	1"	25	29	39	37.5	2	11.6	17.4	
	82176	1 1/4"	32	33	48	46.5	2.4	13.9	19.1	
	82177	1 1/2"	40	37	55	53	2.5	13.9	23.1	
	82178	2"	50	42	67.5	65.5	2.8	17.1	24.9	
	82179	2 1/2"	65	49	84	82	3.3	18.7	30.3	
	82180	3"	80	54	98.5	95.5	3.8	21.8	32.2	
	82181	4"	100	64	124.5	121.5	4.3	26.6	37.4	

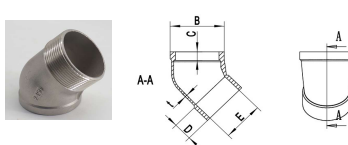
Winkel 45° IG/AG Edelstahl - 1.4408		Artikelnummer	Inch	DN	B	C	D	t	E	Gewindelänge	Z
	82182	1/2"	15	25	9	12.5	1.3	16	9.1	?	
	82183	3/4"	20	31	11.5	12	1.5	22	10.4	?	
	82184	1"	25	38.5	13.5	14	1.8	27	11.6	?	
	82185	1 1/4"	32	48	12.5	18.5	1.8	36	13.9	?	
	82186	1 1/2"	40	54.8	16	19	2.2	40.5	13.9	?	
	82187	2"	50	66.5	16	23	2.5	50.5	17.1	?	

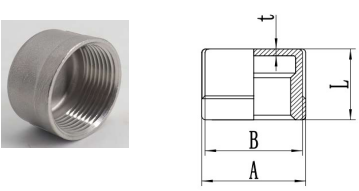
Kappe rund Edelstahl - 1.4408		Artikelnummer	Inch	DN	L	A	B	t	Gewindelänge
	82090	1/8"	6	10.5	14	13	1.6	4.5	
	82091	1/4"	8	14	18	16.5	1.6	6.7	
	82092	3/8"	10	14.5	21.5	20	1.6	7.1	
	82093	1/2"	15	18.5	26	24.5	1.8	9.1	
	82094	3/4"	20	19.5	31.5	30	1.8	10.4	
	82095	1"	25	22.5	39	37.5	2	11.6	
	82096	1 1/4"	32	25.5	48	46.5	2.4	13.9	
	82097	1 1/2"	40	25.5	55	53	2.5	13.9	
	82098	2"	50	30	67.5	65.5	2.8	17.1	
	82099	2 1/2"	65	35	84	82	3.3	18.7	
	8210	3"	80	38.5	98.5	95.5	3.8	21.8	
82101	4"	100	45	124.5	121.5	4.3	26.6		

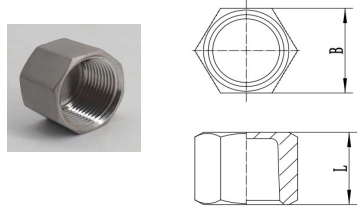
Kappe Hexagon Edelstahl - 1.4408		Artikelnummer	Inch	DN	B	L	Square	Gewindelänge
	82190	1/8"	6	13	12.5	Hex	4.5	
	82191	1/4"	8	16.5	16	Hex	6.7	
	82192	3/8"	10	19.8	16.5	Hex	7.1	
	82193	1/2"	15	24.5	21	Hex	9.1	
	82194	3/4"	20	30	22.5	Oct	10.4	
	82195	1"	25	37	26	Oct	11.6	
	82196	1 1/4"	32	46.5	29	Oct	13.9	
	82197	1 1/2"	40	53	29	Oct	13.9	
	82198	2"	50	65	33.5	Oct	17.1	
	82199	2 1/2"	65	82	38.5	Dec	18.7	
	82200	3"	80	95.5	42	Dec	21.8	

82201	4"	100	120	48	Dec	26.6
-------	----	-----	-----	----	-----	------

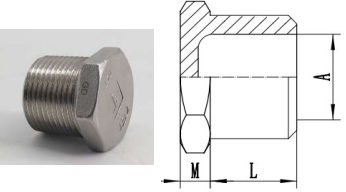
Stopfen Hexagon Edelstahl - 1.4408		Artikelnummer	Inch		DN	L	M	A	Square	Gewindelänge
	82210	1/8"		6	8	4	5.5	Hex	4.5	
	82211	1/4"		8	10.5	4	8	Hex	6.7	
	82212	3/8"		10	11	5	11.5	Hex	7.1	
	82213	1/2"		15	14.5	5	15	Hex	9.1	
	82214	3/4"		20	15.5	5.5	20.5	Oct	10.4	
	82215	1"		25	18	6	26	Oct	11.6	
	82216	1 1/4"		32	20.5	6.5	34.5	Oct	13.9	
	82217	1 1/2"		40	20.5	6.5	40	Oct	13.9	
	82218	2"		50	25	7	51	Oct	17.1	
	82219	2 1/2"		65	27	7	65.5	Oct	18.7	
	82220	3"		80	30	7.5	77.5	Oct	21.8	
	82221	4"		100	36	8	101.5	Oct	26.6	

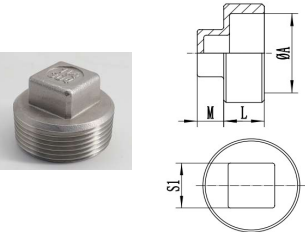
Stopfen 4-kant ohne Rand Edelstahl - 1.4408		Artikelnummer	Inch		DN	L	M	A	S1	Gewindelänge
	82230	1/8"		6	6	5	5.5	7	4.5	
	82231	1/4"		8	8.5	5	8	9	6.7	
	82232	3/8"		10	9	6	11.5	10	7.1	
	82233	1/2"		15	11.5	7	15	11	9.1	
	82234	3/4"		20	13	8	20.5	15	10.4	
	82235	1"		25	14.5	11	26	18	11.6	
	82236	1 1/4"		32	17	11	34.5	20.5	13.9	
	82237	1 1/2"		40	17	12	40	22	13.9	
	82238	2"		50	21.5	13	51	28	17.1	
	82239	2 1/2"		65	23.5	15	65.5	32	18.7	
	82240	3"		80	26.5	15	77.5	36	21.8	
	82241	4"		100	32.5	19	101.5	42	26.6	

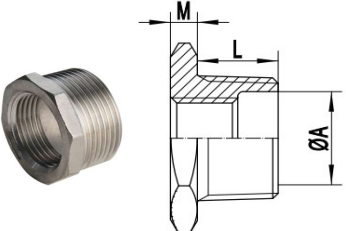
Reduziernippel IG/AG Edelstahl - 1.4408		Artikelnummer	Inch for external thread	Inch for internal thread	DN	A	L	M	Gewindelänge AG	Gewindelänge IG
	82390	1/4"	1/8"	8x6	8	10.5	4.5	6.7	4.5	
	82391	3/8"	1/8"	10x6	11.5	11	4.5	7.1	4.5	
	82392	3/8"	1/4"	10x8	11.5	11	4.5	7.1	6.7	
	82393	1/2"	1/8"	15x6	15	14.5	4.5	9.1	4.5	
	82394	1/2"	1/4"	15x8	15	14.5	5	9.1	6.7	
	82395	1/2"	3/8"	15x10	15	14.5	5	9.1	7.1	
	82396	3/4"	1/8"	20x6	20.6	15.5	5.7	10.4	4.5	
	82397	3/4"	1/4"	20x8	20.6	15.5	5.7	10.4	6.7	
	82398	3/4"	3/8"	20x10	20.6	15.5	5.7	10.4	7.1	
	82399	3/4"	1/2"	20x15	20.6	15.5	5.7	10.4	9.1	
	82401	1"	1/4"	25x8	26.1	17.9	6.2	11.6	6.7	
	82402	1"	3/8"	25x10	26.1	17.9	6.2	11.6	7.1	
	82403	1"	1/2"	25x15	26.1	17.9	6.2	11.6	9.1	
	82404	1"	3/4"	25x20	26.1	17.9	6.2	11.6	10.4	
	82405	1 1/4"	1/2"	32x15	34.7	20.3	6.8	13.9	9.1	
	82406	1 1/4"	3/4"	32x20	34.7	20.3	6.8	13.9	10.4	
	82407	1 1/4"	1"	32x25	34.7	20.3	6.8	13.9	11.6	
	82408	1 1/2"	1/2"	40x15	40.2	20.5	6.8	13.9	9.1	
	82409	1 1/2"	3/4"	40x20	40.2	20.5	6.8	13.9	10.4	
	82410	1 1/2"	1"	40x25	40.2	20.5	6.8	13.9	11.6	
	82411	1 1/2"	1 1/4"	40x32	40.2	20.5	6.8	13.9	13.9	
	82412	2"	1/2"	50x15	51.1	24.8	7	17.1	9.1	
	82413	2"	3/4"	50x20	51.1	24.8	7	17.1	10.4	
	82414	2"	1"	50x25	51.1	24.8	7	17.1	11.6	
	82415	2"	1 1/4"	50x32	51.1	24.8	7	17.1	13.9	
	82416	2"	1 1/2"	50x40	51.1	24.8	7	17.1	13.9	
	82418	2 1/2"	3/4"	65x20	65.8	26.8	7	18.7	10.4	
	82419	2 1/2"	1"	65x25	65.8	26.8	7	18.7	11.6	
	82420	2 1/2"	1 1/4"	65x32	65.8	26.8	7	18.7	13.9	
	82421	2 1/2"	1 1/2"	65x40	65.8	26.8	7	18.7	13.9	
82422	2 1/2"	2"	65x50	65.8	26.8	7	18.7	17.1		
82423	3"	3/4"	80x20	77.5	31	11	21.8	10.4		
82424	3"	1"	80x25	77.5	29.7	8	21.8	11.6		
82425	3"	1 1/4"	80x32	77.5	29.7	7.5	21.8	13.9		
82426	3"	1 1/2"	80x40	77.5	29.7	7.5	21.8	13.9		
82427	3"	2"	80x50	77.5	29.7	7.5	21.8	17.1		

82428	3"	21/2"	80x65	77.8	29.5	7.5	21.8	18.7
82429	4"	2"	100x50	101.8	35.5	8	26.6	17.1
82430	4"	21/2"	100x65	101.8	35.5	8	26.6	18.7
82431	4"	3"	100x80	101.8	35.5	8	26.6	21.8

Rohrverschraubung IG/IG KD Edelstahl - 1.4408		Artikelnummer	Inch	DN	A	B	L1	M	Square	Gewindelänge	Z
	82250	1/8"	6	13	26	30	13	Hex	4.5	21.1	
	82251	1/4"	8	16.5	29	33.5	13.5	Oct	6.7	20.2	
	82252	3/8"	10	20	34	36.5	15	Oct	7.1	22.4	
	82253	1/2"	15	24.5	37	39.5	16	Oct	9.1	21.3	
	82254	3/4"	20	30	44	42.5	17	Oct	10.4	21.7	
	82255	1"	25	37	52.5	50	20	Oct	11.6	26.9	
	82256	1 1/4"	32	46.5	63	54	22	Oct	13.9	26.3	
	82257	1 1/2"	40	53	70	58	24	Oct	13.9	30.3	
	82258	2"	50	65	84	65	27	Oct	17.1	30.9	
	82259	2 1/2"	65	82	101.5	75	29.5	Dec	18.7	37.7	
	82260	3"	80	95.5	118	83	31	Dec	21.8	39.5	
	82261	4"	100	121.5	148.5	110	34	Dec	26.6	56.9	

Rohrverschraubung IG/IG PTFE Edelstahl - 1.4408		Artikelnummer	Inch	DN	A	B	L1	M	Square	Gewindelänge	Z
	82290	1/8"	6	13	26	30	13	Hex	4.5	21.1	
	82291	1/4"	8	16.5	29	33.5	13.5	Oct	6.7	20.2	
	82292	3/8"	10	20	34	36.5	15	Oct	7.1	22.4	
	82293	1/2"	15	24.5	37	39.5	16	Oct	9.1	21.3	
	82294	3/4"	20	30	44	42.5	17	Oct	10.4	21.7	
	82295	1"	25	37	52.5	50	20	Oct	11.6	26.9	
	82296	1 1/4"	32	46.5	63	54	22	Oct	13.9	26.3	
	82297	1 1/2"	40	53	70	58	24	Oct	13.9	30.3	
	82298	2"	50	65	84	65	27	Oct	17.1	30.9	
	82299	2 1/2"	65	82	101.5	75	29.5	Dec	18.7	37.7	
	82300	3"	80	95.5	118	83	31	Dec	21.8	39.5	

Rohrverschraubung AG/IG KD Edelstahl - 1.4408		Artikelnummer	Inch	DN	A	B	L1	L2	M	Square	Gewindelänge IG	Z
	82310	1/8"	6	13	26	30	8	13	Hex	4.5	25.5	
	82311	1/4"	8	16.5	29	33.5	10.5	13.5	Oct	6.7	26.8	
	82312	3/8"	10	20	34	36.5	11	15	Oct	7.1	29.4	
	82313	1/2"	15	24.5	37	39.5	14.5	16	Oct	9.1	30.4	
	82314	3/4"	20	30	44	42.5	15.5	17	Oct	10.4	32.1	
	82315	1"	25	37	52.5	50	18	20	Oct	11.6	38.4	
	82316	1 1/4"	32	46.5	63	54	20.5	22	Oct	13.9	40.1	
	82317	1 1/2"	40	53	70	58	20.5	24	Oct	13.9	44.1	
	82318	2"	50	65	84	65	25	27	Oct	17.1	47.9	
	82319	2 1/2"	65	82	101.5	75	27	29.5	Dec	18.7	56.3	
	82320	3"	80	95.5	118	83	30	31	Dec	21.8	61.2	
	82321	4"	100	121.5	148.5	110	36	34	Dec	26.6	83.4	

Rohrverschraubung AG/IG FD Edelstahl - 1.4408		Artikelnummer	Inch	DN	A	B	L1	L2	M	Square	Gewindelänge IG	Z
	82331	1/4"	8	16.5	29	33.5	10.5	13.5	Oct	6.7	26.8	
	82332	3/8"	10	20	34	36.5	11	15	Oct	7.1	29.4	
	82333	1/2"	15	24.5	37	39.5	14.5	16	Oct	9.1	30.4	
	82334	3/4"	20	30	44	42.5	15.5	17	Oct	10.4	32.1	
	82335	1"	25	37	52.5	50	18	20	Oct	11.6	38.4	
	82336	1 1/4"	32	46.5	63	54	20.5	22	Oct	13.9	40.1	
	82337	1 1/2"	40	53	70	58	20.5	24	Oct	13.9	44.1	
	82338	2"	50	65	84	65	25	27	Oct	17.1	47.9	
	82339	2 1/2"	65	82	101.5	75	27	29.5	Dec	18.7	56.3	
	82340	3"	80	95.5	118	83	30	31	Dec	21.8	61.2	

Rohrverschraubung AG/AG KD Edelstahl - 1.4408		Artikelnummer	Inch	DN	A	B	L1	L2	M	Square	Gewindelänge	Z
	82350	1/8"	6	13	26	30	8	13	Hex	4.5	30	
	82351	1/4"	8	16.5	29	33.5	10.5	13.5	Oct	6.7	33.5	
	82352	3/8"	10	20	34	36.5	11	15	Oct	7.1	36.5	
	82353	1/2"	15	24.5	37	39.5	14.5	16	Oct	9.1	39.5	
	82354	3/4"	20	30	44	42.5	15.5	17	Oct	10.4	42.5	
	82355	1"	25	37	52.5	50	18	20	Oct	11.6	50	
	82356	1 1/4"	32	46.5	63	54	20.5	22	Oct	13.9	54	
	82357	1 1/2"	40	53	70	58	20.5	24	Oct	13.9	58	
	82358	2"	50	65	84	65	25	27	Oct	17.1	65	
	82359	2 1/2"	65	82	101.5	75	27	29.5	Dec	18.7	75	

82360	3"		80	95.5	118	83	30	31	Dec	21.8	83
82361	4"		100	121.5	148.5	110	36	34	Dec	26.6	110

Langnipple Edelstahl - 1.4404

Artikelnummer	Inch		DN	L	A	E	Gewindelänge	Z
82753	1/8"		6	40	11	1.73	11	18
82783	1/4"		8	40	11	2	11	18
82813	3/8"		10	40	12	2.1	12	16
82845	1/2"		15	60	15	2.5	15	30
82875	3/4"		20	60	17	2.5	17	26
82905	1"		25	60	19	3	19	22
82937	1 1/4"		32	80	22	3.2	22	36
82967	1 1/2"		40	80	22	3.3	22	36
82993	2"		50	100	26	3.5	26	48
83019	2 1/2"		65	100	32	4.6	32	36

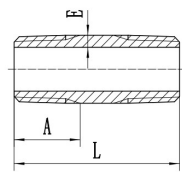

Langnippel Edelstahl - 1.4404

Artikelnummer	Inch		DN	L	A	E	Gewindelänge	Z
82753	1/8"		6	40	8	1.73	8	24
82755	1/8"		6	60	8	1.73	8	44
82757	1/8"		6	80	8	1.73	8	64
82759	1/8"		6	100	8	1.73	8	84
82761	1/8"		6	120	8	1.73	8	104
82783	1/4"		8	40	11	2	11	18
82785	1/4"		8	60	11	2	11	38
82787	1/4"		8	80	11	2	11	58
82789	1/4"		8	100	11	2	11	78
82791	1/4"		8	120	11	2	11	98
82813	3/8"		10	40	12	2.1	12	16
82814	3/8"		10	50	12	2.1	12	26
82815	3/8"		10	60	12	2.1	12	36
82816	3/8"		10	70	12	2.1	12	46
82818	3/8"		10	90	12	2.1	12	66
82819	3/8"		10	100	12	2.1	12	76
82821	3/8"		10	120	12	2.1	12	96
82824	3/8"		10	150	12	2.1	12	126
82829	3/8"		10	200	12	2.1	12	176
82843	1/2"		15	40	15	2.5	15	10
82844	1/2"		15	50	15	2.5	15	20
82845	1/2"		15	60	15	2.5	15	30
82846	1/2"		15	70	15	2.5	15	40
82848	1/2"		15	90	15	2.5	15	60
82849	1/2"		15	100	15	2.5	15	70
82851	1/2"		15	120	15	2.5	15	90
82852	1/2"		15	130	15	2.5	15	100
82853	1/2"		15	140	15	2.5	15	110
82854	1/2"		15	150	15	2.5	15	120
82855	1/2"		15	160	15	2.5	15	130
82856	1/2"		15	170	15	2.5	15	140
82857	1/2"		15	180	15	2.5	15	150
82858	1/2"		15	190	15	2.5	15	160
82859	1/2"		15	200	15	2.5	15	170
82860	1/2"		15	250	15	2.5	15	220
82861	1/2"		15	300	15	2.5	15	270
82873	3/4"		20	40	17	2.5	17	6
82874	3/4"		20	50	17	2.5	17	16
82875	3/4"		20	60	17	2.5	17	26
82876	3/4"		20	70	17	2.5	17	36
82877	3/4"		20	80	17	2.5	17	46
82878	3/4"		20	90	17	2.5	17	56
82879	3/4"		20	100	17	2.5	17	66
82880	3/4"		20	110	17	2.5	17	76
82881	3/4"		20	120	17	2.5	17	86
82882	3/4"		20	130	17	2.5	17	96
82883	3/4"		20	140	17	2.5	17	106
82884	3/4"		20	150	17	2.5	17	116
82885	3/4"		20	160	17	2.5	17	126
82886	3/4"		20	170	17	2.5	17	136
82887	3/4"		20	180	17	2.5	17	146
82888	3/4"		20	190	17	2.5	17	156
82889	3/4"		20	200	17	2.5	17	166
82890	3/4"		20	250	17	2.5	17	216



82891	3/4"		20	300	17	2.5	17	266
82904	1"		25	50	19	3	19	12
82905	1"		25	60	19	3	19	22
82906	1"		25	70	19	3	19	32
82907	1"		25	80	19	3	19	42
82908	1"		25	90	19	3	19	52
82909	1"		25	100	19	3	19	62
82910	1"		25	110	19	3	19	72
82911	1"		25	120	19	3	19	82
82912	1"		25	130	19	3	19	92
82913	1"		25	140	19	3	19	102
82914	1"		25	150	19	3	19	112
82915	1"		25	160	19	3	19	122
82916	1"		25	170	19	3	19	132
82917	1"		25	180	19	3	19	142
82918	1"		25	190	19	3	19	152
82919	1"		25	200	19	3	19	162
82920	1"		25	250	19	3	19	212
82921	1"		25	300	19	3	19	262
82934	11/4"		32	50	22	3.2	22	6
82935	11/4"		32	60	22	3.2	22	16
82936	11/4"		32	70	22	3.2	22	26
82937	11/4"		32	80	22	3.2	22	36
82938	11/4"		32	90	22	3.2	22	46
82939	11/4"		32	100	22	3.2	22	56
82940	11/4"		32	110	22	3.2	22	66
82941	11/4"		32	120	22	3.2	22	76
82943	11/4"		32	140	22	3.2	22	96
82944	11/4"		32	150	22	3.2	22	106
82945	11/4"		32	160	22	3.2	22	116
82947	11/4"		32	180	22	3.2	22	136
82949	11/4"		32	200	22	3.2	22	156
82964	11/2"		40	50	22	3.3	22	6
82965	11/2"		40	60	22	3.3	22	16
82966	11/2"		40	70	22	3.3	22	26
82967	11/2"		40	80	22	3.3	22	36
82968	11/2"		40	90	22	3.3	22	46
82969	11/2"		40	100	22	3.3	22	56
82971	11/2"		40	120	22	3.3	22	76
82973	11/2"		40	140	22	3.3	22	96
82974	11/2"		40	150	22	3.3	22	106
82975	11/2"		40	160	22	3.3	22	116
82977	11/2"		40	180	22	3.3	22	136
82979	11/2"		40	200	22	3.3	22	156
82993	2"		50	50	26	3.5	26	-2
82994	2"		50	60	26	3.5	26	8
82995	2"		50	70	26	3.5	26	18
82996	2"		50	80	26	3.5	26	28
82997	2"		50	90	26	3.5	26	38
82998	2"		50	100	26	3.5	26	48
82999	2"		50	120	26	3.5	26	68
83001	2"		50	150	26	3.5	26	98
83004	2"		50	200	26	3.5	26	148
83019	2 1/2"		65	100	32	4.6	32	36
83020	2 1/2"		65	120	32	4.6	32	56
83021	2 1/2"		65	140	32	4.6	32	76
83022	2 1/2"		65	160	32	4.6	32	96
83023	2 1/2"		65	180	32	4.6	32	116
83024	2 1/2"		65	200	32	4.6	32	136
83036	3"		80	100	34	5	34	32
83037	3"		80	120	34	5	34	52
83039	3"		80	160	34	5	34	92
83041	3"		80	200	34	5	34	132
83058	4"		100	120	40	5.5	40	40

Schweissnippel Edelstahl - 1.4404

Artikelnummer	Inch	DN	L	A	E	Gewindelänge	Z
82580	1/8"	6	30	8	1.73	8	22
82581	1/4"	8	30	11	2	11	19
82582	3/8"	10	30	12	2.1	12	18
82583	1/2"	15	35	15	2.5	15	20



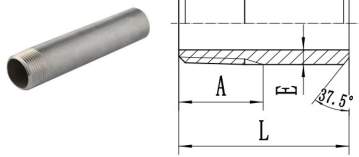

82584	3/4"	20	40	17	2.5	17	23
82585	1"	25	40	19	3	19	21
82586	1 1/4"	32	50	22	3.2	22	28
82587	1 1/2"	40	50	22	3.3	22	28
82588	2"	50	50	26	3.5	26	24
82589	2 1/2"	65	60	32	4.6	32	28
82590	3"	80	70	34	5	34	36
82591	4"	100	80	40	5.5	40	40

Gewindenippel Edelstahl - 1.4404

Artikelnummer	Inch	DN	L	C
82640	3/8"	10	32	12.95
82641	1/2"	15	35	16.34
82642	3/4"	20	40	21.67
82643	1"	25	40	27.4
82644	1 1/4"	32	51	35.76
82645	1 1/2"	40	51	41.66
82646	2"	50	51	53.55

Gewindemuffe Edelsthal - 1.4404

Artikelnummer	Inch	DN	L	B
82600	1/8"	6	17	13
82601	1/4"	8	24	16.5
82602	3/8"	10	25	20
82603	1/2"	15	32	24.5
82604	3/4"	20	35	30
82605	1"	25	41	37
82606	1 1/4"	32	45	46.5
82607	1 1/2"	40	45	53
82608	2"	50	54	65
82609	2 1/2"	65	63	81.5
82610	3"	80	69	95
82611	4"	100	81	121.5

Gewindemuffe kurz Edelsthal - 1.4404

Artikelnummer	Inch	DN	L	B
82620	1/8"	6	7.5	13
82621	1/4"	8	11	16.5
82622	3/8"	10	11.5	20
82623	1/2"	15	15	24.5
82624	3/4"	20	16.5	30
82625	1"	25	19.5	37
82626	1 1/4"	32	21.5	46.5
82627	1 1/2"	40	21.5	53
82628	2"	50	26	65
82629	2 1/2"	65	30.5	81.5
82630	3"	80	33.5	95
82631	4"	100	39.5	121.5